

Lighting Control Engine 3 mx UL



Lighting Control Engine 3 mx UL

The LCE3MX UL with its UL certification is especially designed for the American market for the control of small to medium projects. It comes with a full SYMPHOLIGHT and LAS license and thus offers the greatest flexibility. As a central control unit, this versatile lighting control server orchestrates all devices and fixtures within a project. With the ability to output e:net and the capability to integrate various external engines, triggers, and other desired devices and content, the LCE3MX UL is an ultimate solution for demanding projects: from automation to DALI projects up to medium architectural illumination. The LCE3MX UL can be mounted on walls and in 19 inch racks mounted on a rack drawer.

Highlights

- Equipped with e:cue's SYMPHOLIGHT and Lighting Application Suite programs and licenses
- UL certified
- High quality components for reliable uninterrupted operation, certified for industrial use
- Fanless operation, SSD drive, no moving or rotating parts
- Support for a variety of Ethernet-based protocols
- Supports headless operation (no keyboard and monitor connected)
- Power supply unit included
- Perfectly balanced server for 24/7 use of SYMPHOLIGHT
- Windows 10 LTSC, 10 years security updates
- 5 years support and warranty

e:cue Server

Designed to control large and complex projects, our Lighting Engines are high-performance servers with pre-installed SYMPHOLIGHT and the Lighting Application Suite (LAS) software. As central control unit, this versatile server guarantees uninterrupted operation as it orchestrates all devices and fixtures within a project. e:cue Server Range is scalable to cover any project requirements.

Delivery scope

- e:cue Lighting Control Engine 3 mx UL
- SYMPHOLIGHT and LAS license dongle, integrated
- Microsoft® Windows 10™ LTSC
- Power supply unit
- Power cords with US plug and Schuko plug
- Wallmount kit, pre-installed
- Welcome card, Safety instructions, Update note, Login credentials

Identcode

CL23100105835

Optional Accessories

- Ethernet Data Cable (RJ45)
- SYMPL Switch

Identcode

AA556130055

AM313830035

Product specification

Dimensions (W x H x D)	160 x 123 x 50 mm / 6.3 x 4.84 x 1.97 in (excl. mounting brackets)
Weight	1.16 kg / 2.56 lb (excl. mounting brackets)
Power supply	19 ... 24 V DC, 5 A Power supply unit: input: 100 ... 240 V AC, 50/60 Hz, 1.4 A output: 20 V DC, 6 A, 120 W max.
Power consumption	120 W
Operating temperature	0 ... 50 °C / 32 ... 122 °F
Storage temperature	-10 ... 85 °C / 14 ... 185 °F
Op. / storage humidity	0 ... 90 %
Housing	Aluminum, steel
Mounting	Wall mounting
Battery	Yes (1)
Certifications	FCC, UL

Engine

Operating system	Microsoft® Windows 10™ LTSC
LAN chipset	2 x Gigabit Ethernet, Wake on LAN function
System connection ports	2 x e.net, RJ45 4 x USB 3.2 2 x USB Type C, Thunderbolt 4 2 x DisplayPort 1.4 1 x RS-232
Data storage	128 GByte SSD mSATA HDD
User interfaces	Power button

Dimensions

All measures in mm

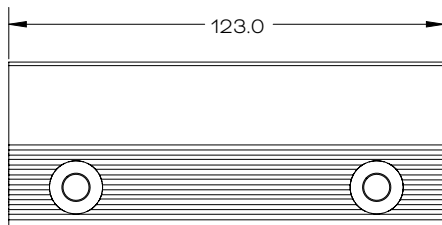
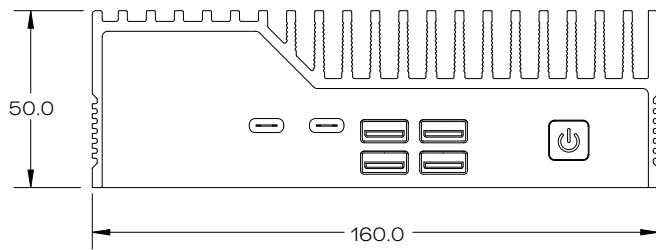

Connectivity

